

Model 620T

Installation Instructions

ASSEMBLY:

- Step 1.** Take the two frames (Part#7) and connect them to the curved support bar (Part#8). See diagram
- Step 2.** Once the curved support bar is connected to the main frame's, place the support beam (Part#9) onto the frame and proceed to position the screws and 1/4" washers into the assigned holes. Loosely tighten the nuts down.
- Step 3.** Now that the frame is connected, take the axle (Part#11) and proceed to slide the axle into the back of the frame while holding the support spacer in between the two halves of the connected frame. Once you push the axle through one of the bottom fabricated holes on the base of the frame, slide the support spacer over the axle and proceed to connect the axle to the frame. Once the axle is placed onto the frame apply the 4 wheels, (4) 9/16" washers and 2 cotter pins (Note: We recommend one 9/16" washer on each side of every wheel). See diagram
- Step 4.** Apply the handle (Part#10) to the frame and tighten down each and every screw and nut.
- Step 5.** Finished

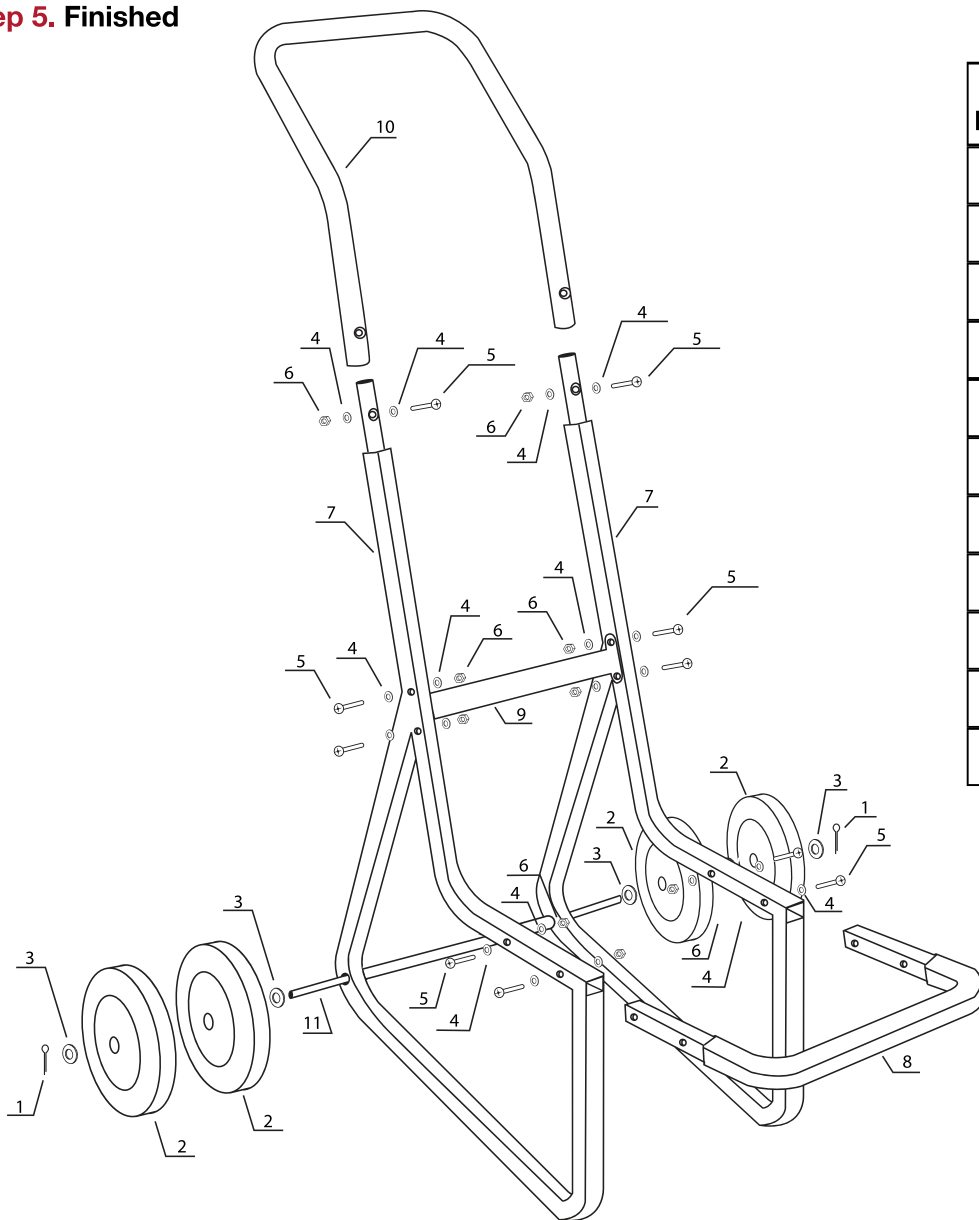

PART NUMBER	HARDWARE	QUANTITY
1	Cotter Pin	x 2
2	Wheel	x 4
3	9/16" Washer	x 4
4	1/4" Washer	x 20
5	Bolt	x 10
6	Nut	x 10
7	Frame	x 2
8	Curved Support Bar	x 1
9	Support Beam	x 1
10	Handle	x 1
11	Axle	x 1