

Model Markerboard Installation Instructions

ASSEMBLY:

- Step 1.** Determine desired height of board from floor and snap a level chalk line. Affix L-Brackets to the wall with the bottom of the 90 degree angle at the chalk line.
- Step 2.** Slide marker tray on to the bottom of the board. Once tray is secured on to the board move to Step 3.
- Step 3.** While board is setting on bottom L-Brackets, mark location for L-Brackets on top and side of board. Remove board from bottom L-Bracket. Install L-Brackets on top and side marked locations. Reposition board inside L-Bracket, drill and screw board into place. Confirm board is securely installed.
- Step 4.** Two piece boards require installation of a Cover Bar, simply peel and stick onto the adjoining frames for a seamless look.

PART NUMBER	HARDWARE
1	L - Bracket
2	Screw
3	Cover Bar
4	Marker Tray
5	Marker Board Frame

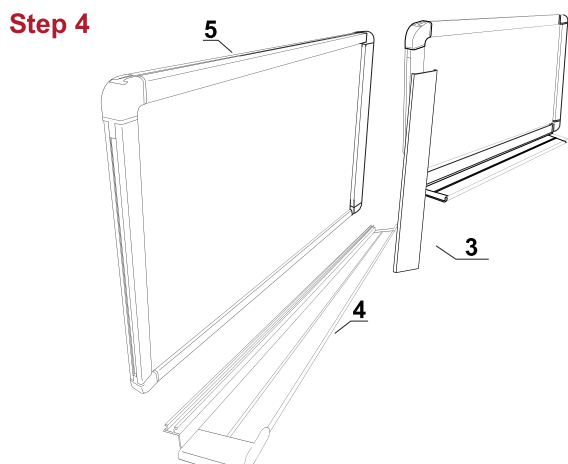
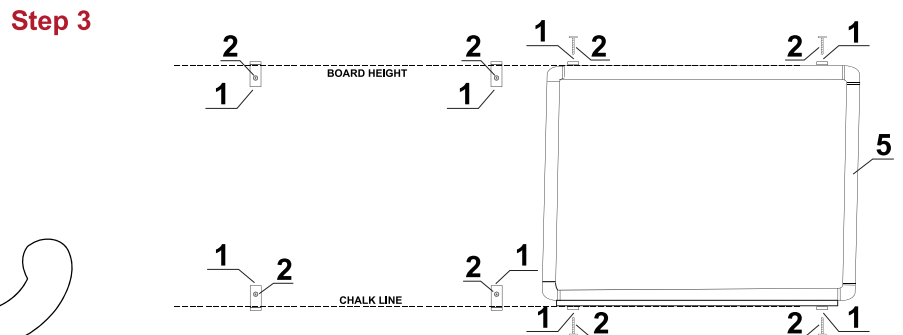
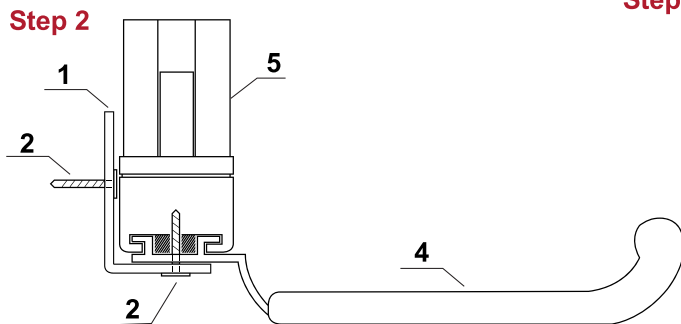
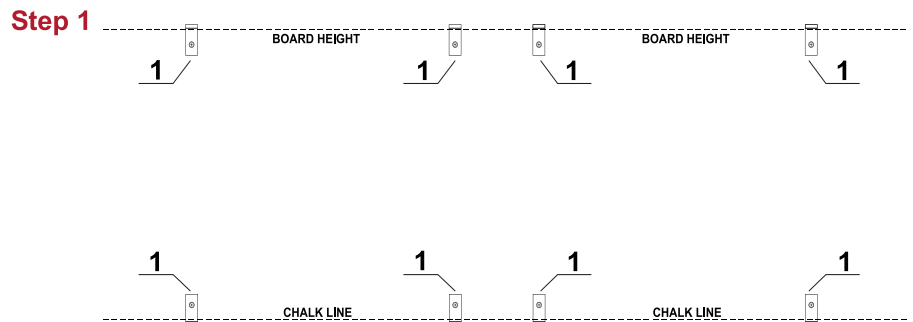

Finished

